



SK22A THRU SK220A

SURFACE MOUNT SCHOTTKY BARRIER RECTIFIER

REVERSE VOLTAGE: 20 to 200 VOLTS
FORWARD CURRENT: 2.0 AMPERE

FEATURES

- Plastic package has Underwriters Laboratory Flammability Classification 94V-O
- For surface mounted applications
- High current capacity
- Low profile package
- Suffix " H " indicated Halogen-free part, ex.SK22AH

MECHANICAL DATA

Case : Molded plastic, DO-214AC(SMA)
 Terminals : Solder plated, solderable per MIL-STD-750, method 2026 guaranteed
 Polarity : Color band denotes cathode end

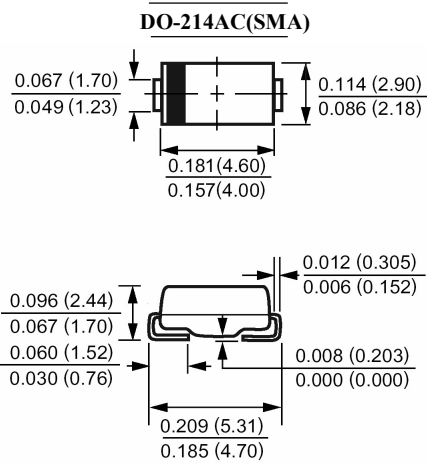

Dimensions in inch and (millimeter)

Maximum Ratings and Electrical Characteristics

Ratings at 25°C ambient temperature unless otherwise specified.

Single phase, half wave, 60Hz, resistive or inductive load.

For capacitive load, derate current by 20%.

Parameter	Symbols	SK22A	SK23A	SK24A	SK25A	SK26A	SK28A	SK210A	SK215A	SK220A	Units	
		SK22	SK23	SK24	SK25	SK26	SK28	SK210	SK215	SK220		
Maximum Recerrent Peak Reverse Voltage	V_{RRM}	20	30	40	50	60	80	100	150	200	Volts	
Maximum RMS Voltage	V_{RMS}	14	21	28	35	42	56	71	105	140	Volts	
Maximum DC Blocking Voltage	V_{DC}	20	30	40	50	60	80	100	150	200	Volts	
Maximum Average Forward Rectified Current at T_L (See Fig. 1)	$I_{(AV)}$	2.0									Amp	
Peak Forward Surge Current, 8.3ms single half-sine-wave superimposed on rated load (JEDEC method)	I_{FSM}	50.0									Amp	
Maximum Forward Voltage at 2.0A (Note 1)	V_F	0.55			0.75		0.85		0.95		Volts	
Maximum Reverse Current at $T_A=25^\circ\text{C}$ at Rated DC Blocking Voltage $T_A=100^\circ\text{C}$	I_R	0.5					0.2					mAmp
		15.0					5.0					
Typical Thermal Resistance (Note 2)	$R_{\theta JL}$	35.0									°C/W	
Operating Junction Temperature Range	T_J	-65 to +125						-65 to +150				°C
Storage Temperature Range	T_{stg}	-65 to +150									°C	

Notes :

1- Pulse test: 300µs pulse width, 2% duty cycle

2- Mounted on P.C.B. with 0.2 x 0.2" (5.0 x 5.0mm) copper pad areas.



SK22A THRU SK220A

SURFACE MOUNT SCHOTTKY BARRIER RECTIFIER

RATINGS AND CHARACTERISTIC CURVES

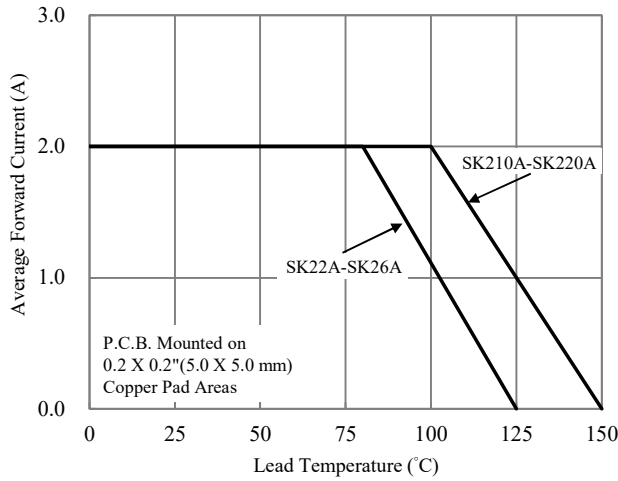

Fig.1-Forward Current Derating Curve

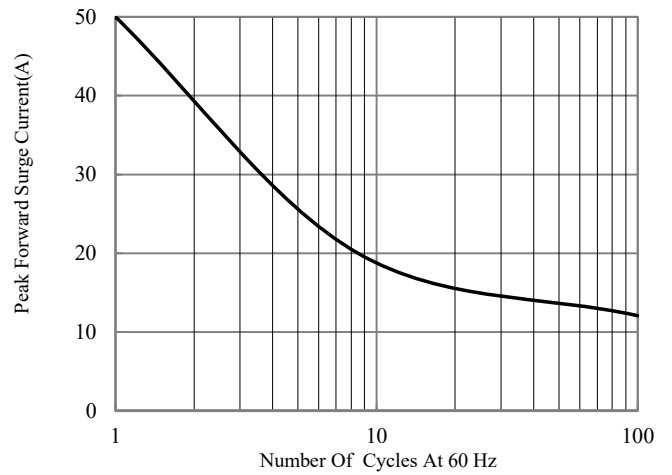

Fig.2-Maximum Non-Repetitive Peak Forward Surge Current

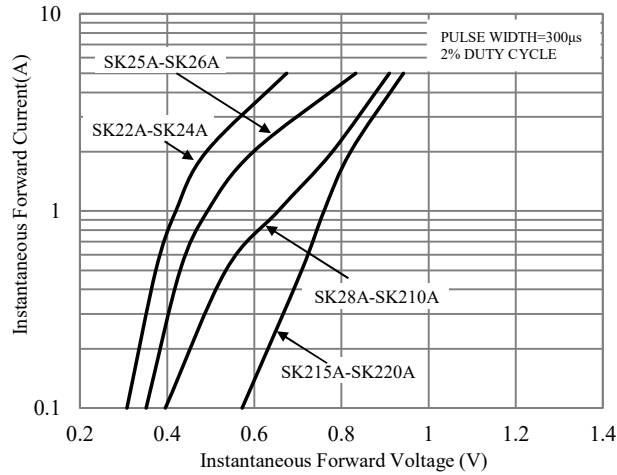

Fig.3-Typical Instantaneous Forward Characteristics

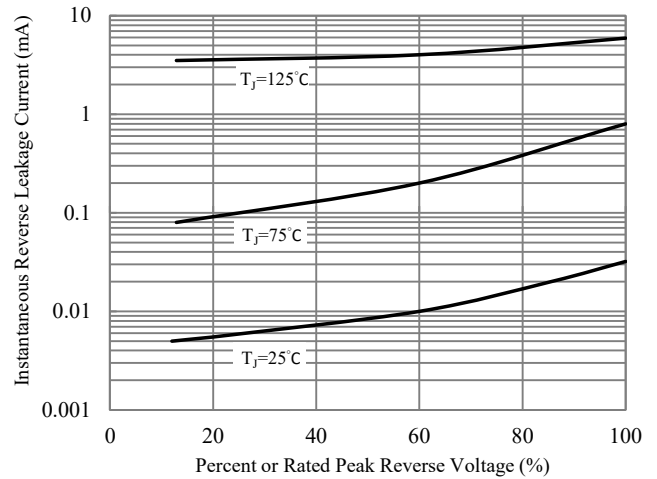

Fig.4-Typical Reverse Leakage Characteristics



SK22A THRU SK220A

SURFACE MOUNT SCHOTTKY BARRIER RECTIFIER

TAPE & REEL SPECIFICATION

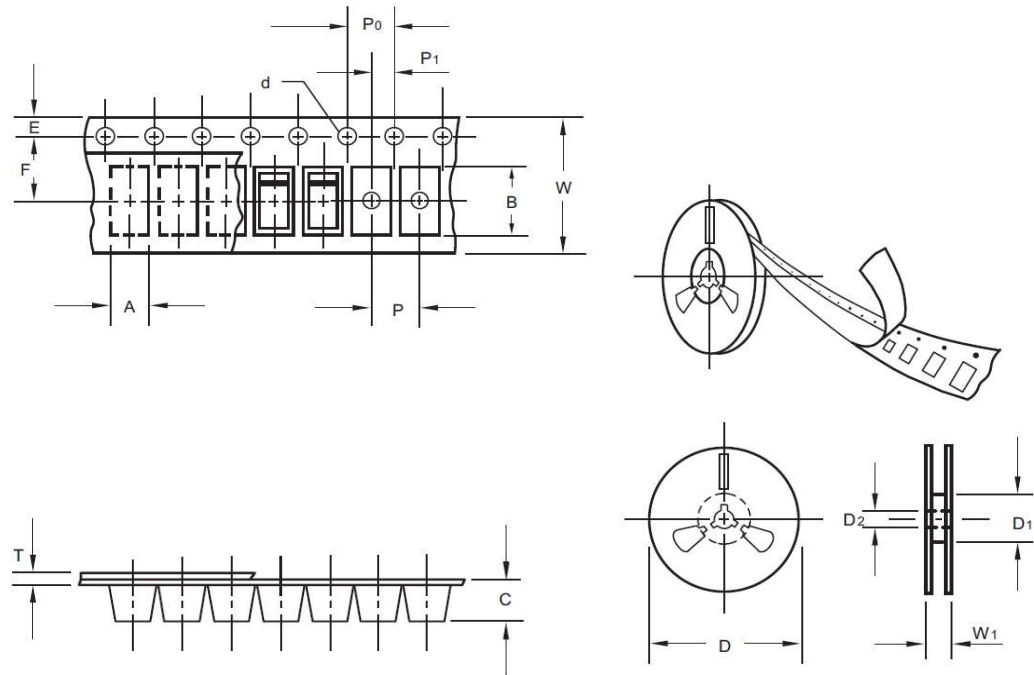

unit: mm

Item	Symbol	DO-214AC (SMA)
Carrier width	A	3.00 ± 0.10
Carrier length	B	5.40 ± 0.10
Carrier depth	C	2.40 ± 0.10
Sprocket hole	d	1.50 ± 0.10
Reel outside diameter	D	330.0 ± 2.0
Reel inner diameter	D1	50 min.
Feed hole diameter	D2	13.00 ± 0.50
Stroket hole position	E	1.50 ± 0.10
Punch hole position	F	5.65 ± 0.05
Punch hole pitch	P	4.00 ± 0.10
Sprocket hole pitch	P ₀	4.00 ± 0.10
Embossment center	P ₁	2.00 ± 0.10
Totall tape thickness	T	0.30 ± 0.05
Tape width	W	12.00 ± 0.20
Reel width	W1	16.80 ± 2.00

ORDER INFORMATION

Package	Reel Size	Quantity
SMA	13"	5,000



SK22A THRU SK220A

SURFACE MOUNT SCHOTTKY BARRIER RECTIFIER

SUGGESTED SOLDER PAD LAYOUT

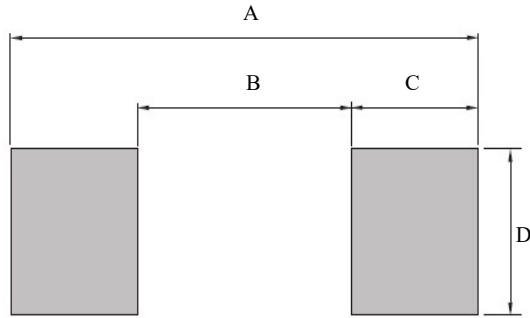

Unit : mm

PACKAGE	A	B	C	D
DO-214AC(SMA)	6.50	1.50	2.50	1.70