



SE05S6BMD5

ESD PROTECTION DIODE

FEATURES

- 60W Peak Pulse Power per Line ($t_p=8/20\mu s$)
- IEC61000-4-2(ESD) 15kV(air), 8kV(Contact)
- IEC61000-4-4(EFT) 40A(5/50ns)
- Protects I/O Port
- Low Clamping Voltage
- Low Leakage current
- Bi-directional Configurations
- Suffix " H " indicated Halogen-free part, ex.SE05S6BMD5H

APPLICATIONS

- High Speed Line :USB1.0/2.0, VGA, DVI, SDI,
- Serial and Parallel Ports
- Notebooks, Desktops, Servers
- Projection TV
- Cellular handsets and accessories

MECHANICAL DATA

Case : SOD-523

PIN CONFIGURATION

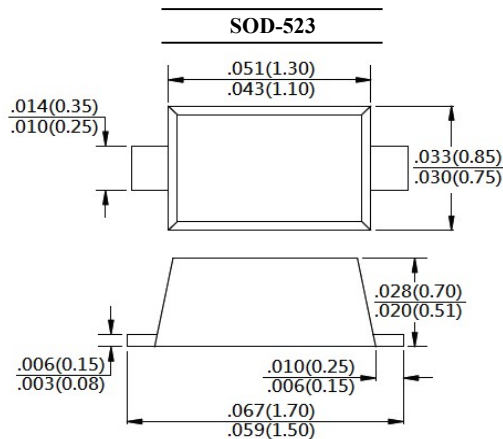
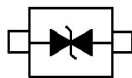

Dimensions in inches and (millimeters)

Maximum Ratings (Rating at 25°C ambient temperature unless otherwise specified)

Parameter	Symbol	Value	Units
Peak Pulse Power ($t_p = 8/20\mu s$)	P_{PP}	60	W
ESD per IEC 61000-4-2 (Air)	V_{ESD}	15	kV
ESD per IEC 61000-4-2 (Contact)		8	
Operating Junction Temperature Range	T_J	-55 to +125	°C
Storage Temperature Range	T_{STG}	-55 to +150	°C



SE05S6BMD5

ESD PROTECTION DIODE

Symbol	Parameter
V_{RWM}	Working Peak Reverse Voltage
V_{PT}	Punch-Through Voltage@ I_{PT}
V_{SB}	Snap-Back Voltage@ I_{SB}
V_C	Clamping Voltage @ I_{PP}
I_R	Reverse Leakage Current @ V_{RWM}
I_{SB}	Test Current for Reverse Breakdown
I_{PP}	Maximum Peak Pulse Current
C_j	Capacitance

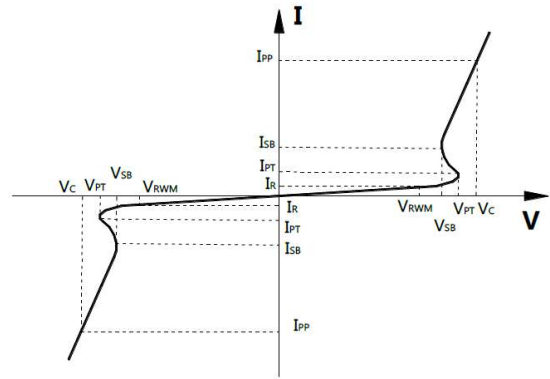

Electrical Characteristics Per line @ 25°C Unless Otherwise Specified

Part Numbers	V_{RWM}	I_R	V_{SB}	I_T	V_c @ $I_{PP}=1A$	C_j @ $V_R=0V, 1MHz$	
	(V)	(μA)	Min.(V)	(mA)	(V)	Typ.(pF)	Max.(pF)
SE05S6BMD5	5.0	1.0	5.2	50.0	9.0	3.0	6.0



SE05S6BMD5

ESD PROTECTION DIODE

RATINGS AND CHARACTERISTIC CURVES

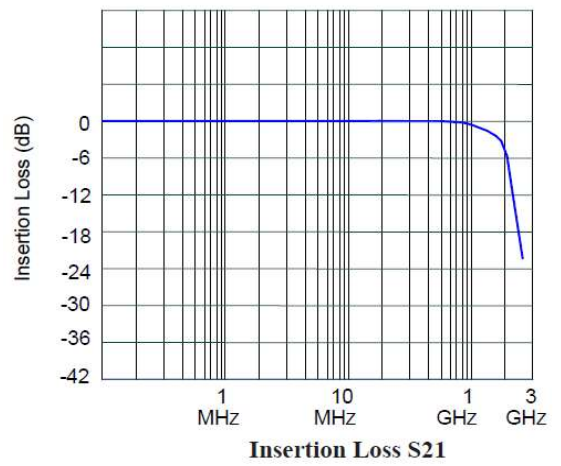
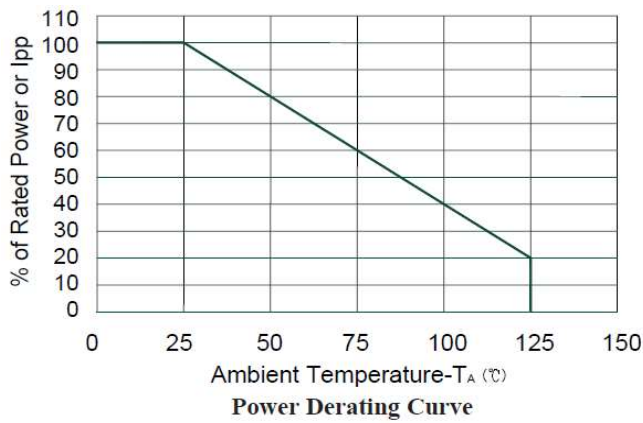
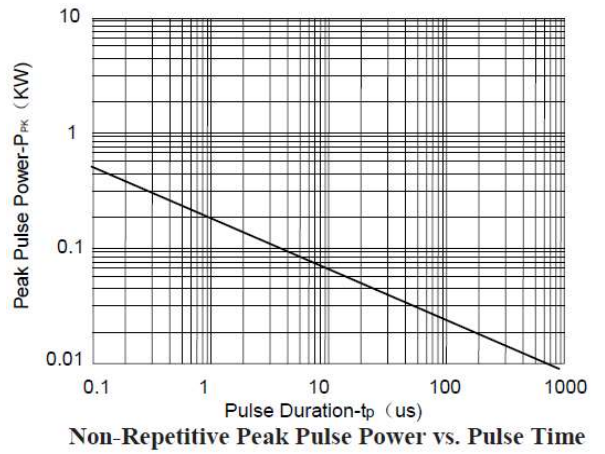
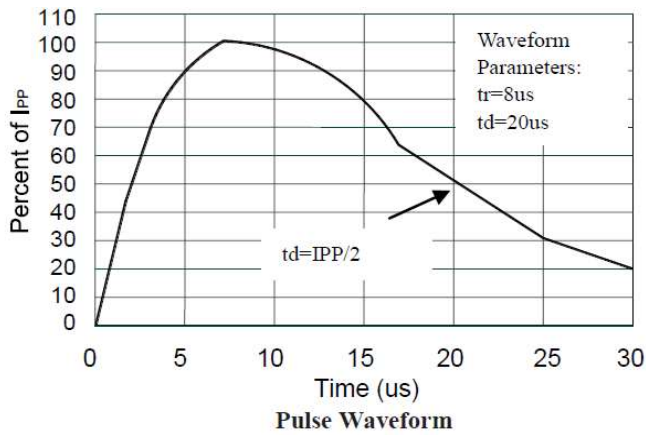



SE05S6BMD5

ESD PROTECTION DIODE

TAPE & REEL SPECIFICATION

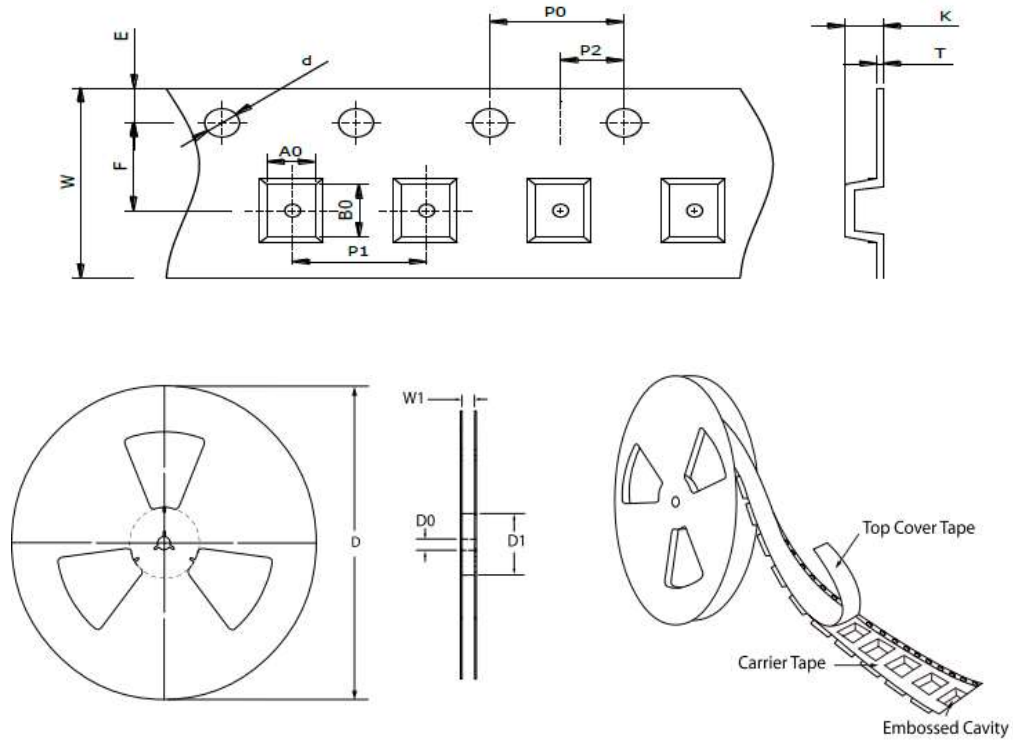

Item	Symbol	SOD-523
Carrier width	A ₀	0.80 ± 0.10
Carrier length	B ₀	1.95 ± 0.10
Carrier depth	K	0.50 ± 0.10
Sprocket hole	d	1.50 ± 0.10
Reel outside diameter	D	178.00 ± 2.00
Feed hole width	D ₀	13.00 ± 0.20
Reel inner diameter	D ₁	MIN. 54.00
Sprocket hole position	E	1.75 ± 0.10
Punch hole position	F	3.50 ± 0.10
Sprocket hole pitch	P ₀	4.00 ± 0.10
Punch hole pitch	P ₁	4.00 ± 0.10
Embossment center	P ₂	2.00 ± 0.10
Overall tape thickness	T	0.25 ± 0.05
Tape width	W	8.00 ± 0.20
Reel width	W1	MAX. 13.50

ORDER INFORMATION

Package	Reel Size	Quantity
SOD-523	7"	3,000



SE05S6BMD5

ESD PROTECTION DIODE

SUGGESTED SOLDER PAD LAYOUT

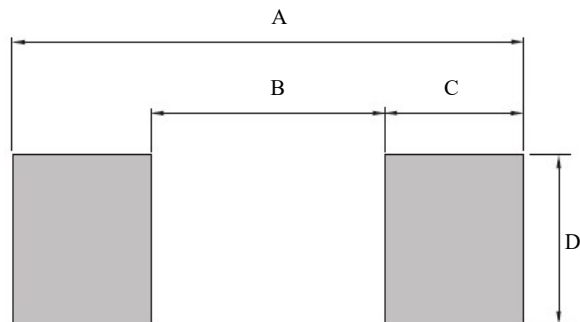

Unit : mm

PACKAGE	A	B	C	D
SOD-523	2.02	0.82	0.60	0.70